

Office to let

Floreasca Park - Building A

Bucharest, Sector 2, 43 Pipera Street



Building information

Building status	Existing
Year of construction	2013
Parking ratio	1 / 100 sq m
Total building area	12 551 sq m

Commercial terms

Office space*	after login *
Parking	after login *
Service charge*	after login *
Minimum lease term	after login *
Availability	after login *

* Asking terms for m²/month

Location

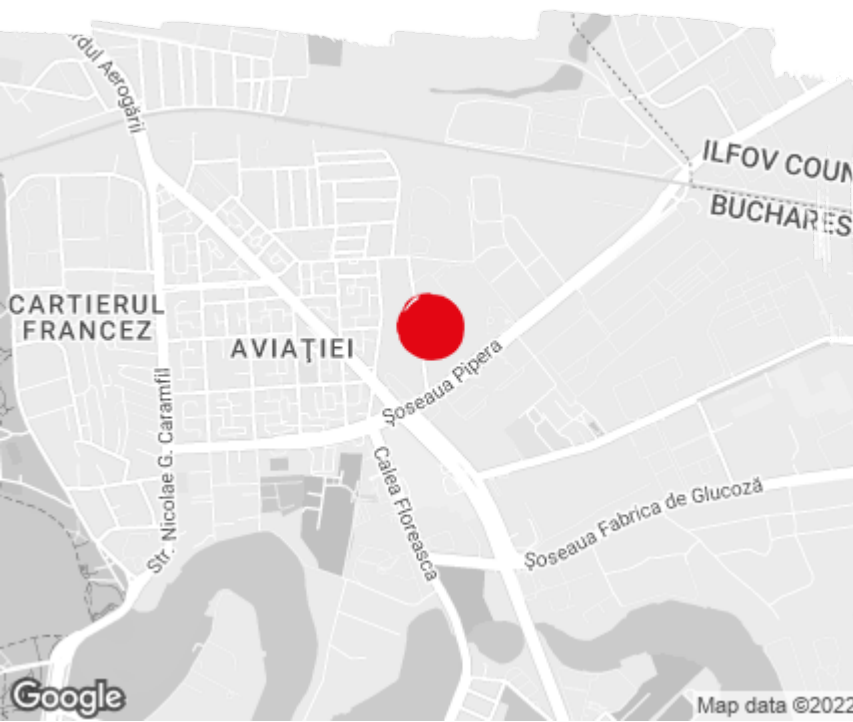

Available space

Building completely leased

Typical floor plan

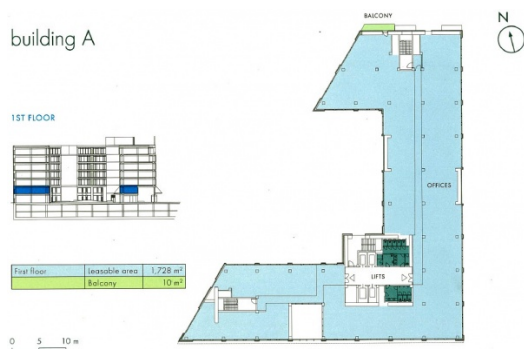

Public transport

Metro: M2

Bus: 112, 135, 243, 343

Tram: 5

Contact



+40 21 302 3400

More information